



# Tomahawk Live Trap llc

[www.livetrap.com](http://www.livetrap.com)

Manufacturing Traps and Cages Since 1925

Po Box 155, Hazelhurst, WI 54531 ● [trapem@livetrap.com](mailto:trapem@livetrap.com)  
800-272-8727 ● Customer Service: 715-356-4600 ● Fax: 715-356-4611

## SETTING THE BAILEY BEAVER TRAP

You can watch this trap being set on U-Tube at [www.youtube.com/tomahawklivetrap](http://www.youtube.com/tomahawklivetrap)

1. Rotate trap so it stands upright on the support bar(3). The support bar should lay flat on the ground, perpendicular to the frame bar(2). The trap jaws(1) are attached to the frame bar(2).
2. Make sure the trip cables(15) are turned the right way so they can extend out along the length of the frame bar(2). The trip cables(15) cannot bind on the mesh for the trap to work effectively.
3. Open jaws(1) one at a time pulling them all the way down to the frame bar(2). Place safety latches(13) over each jaw(1) to hold them down in the open position. After the jaws are secured, you can prepare the trap for setting.
4. Set the trip spring(16) with the “T-Bar” trigger(18). To do so, squeeze the trip spring(16) together with one hand and place the “T-Bar” trigger(18) down on top of the trip spring(16) with the sheet metal flaps pointing down and securing the trip spring. The T-Bar trigger should look like an upright “T” when the trigger is set. Note: You can adjust the triggering sensitivity by bending the sheet metal flaps of the T-Bar trigger in or out. In is less sensitive and out is more sensitive. It is best to use pliers to adjust the sheet metal flaps. It should not be attempted while setting the trap.
5. Make sure the trip cables(15) run alongside the frame bar(2). The trip cables must be positioned so they will not get bound up or caught in the mesh or between the mesh and frame bar(2) when the trap springs shut. There are two trip cables(15) which connect the trip spring(16) at one end to the jaw release trip rods(10) at the other end.
6. Now put the jaw release trip rod(10) over the trap jaw(1) and slide the loop of the trip cable release(17) into it. Do this for both jaws. The jaw release trip rod(10) should be protruding through the loop of the trip cable release(17). Unhook the safety latches(13) and the trap is now deployed.

Note: It is best to practice setting your trap on dry land before attempting it in water the first time. After you set the trap, throw a glove or object at the trigger to see how the trap springs shut. **\*\*CAUTION\*\*** The trap springs shut with great force so be sure to stand back and keep arms and legs free when setting and triggering the trap.

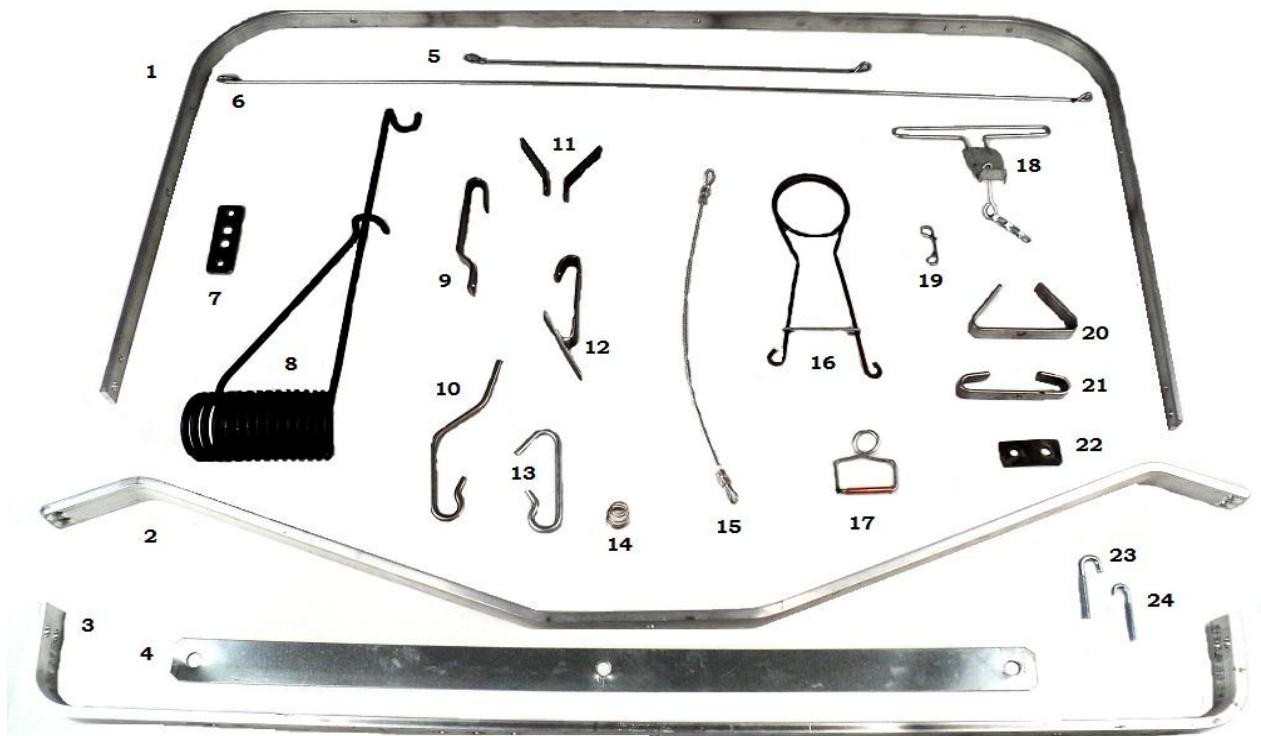

### Bailey Beaver Trap Parts List

1. Trap Jaw – Aluminum
2. Frame Bar – Aluminum
3. Support Bar – Aluminum
4. Washer Bar – Sheet Metal
5. Short mesh attachment rod
6. Long mesh attachment rod
7. Jaw Hinge Plate
8. Jaw Spring
9. Jaw Spring Riser Bar
10. Jaw Release Trip Rod
11. Jaw Guide Bars
12. Jaw Lock Clasp
13. Safety Latch
14. Jaw Lock Clasp Spring
15. Trip Cable
16. Trip Spring
17. Trip Cable Release
18. T-Bar Trigger
19. Trigger Attachment
20. Trigger Restraint Bar
21. Trigger Guard Bar
22. Trip Spring Clamp
23. Large J-Bolts to attach mesh to jaw corners.
24. Small J-Bolts to attach mesh to jaw.