

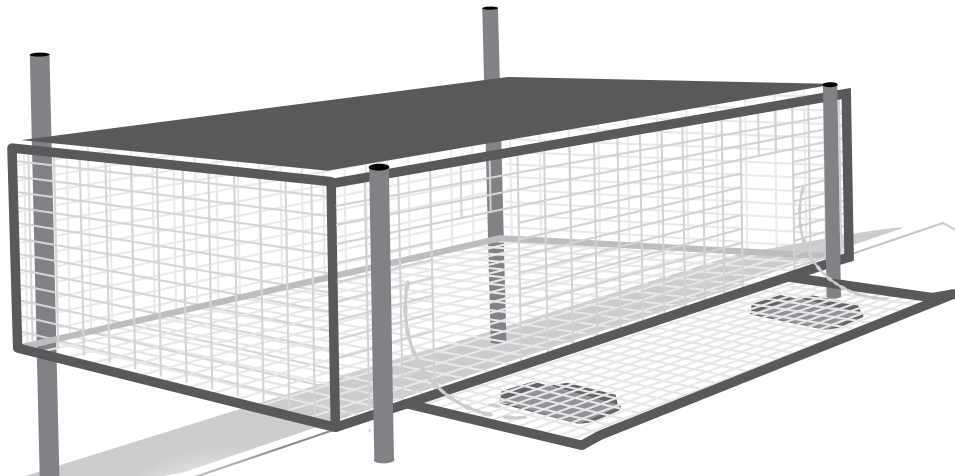

Tomahawk llc.
LIVE • TRAP

Roof Top Pigeon Trap

Model PT3624SL



Large rigid pigeon trap designed for roof tops, even pitched roofs! Adjustable legs at each corner allow this trap to be leveled on almost any roof. Legs have plastic inserts to prevent roof damage. This trap has six trap doors with door guards located on all sides. And drop down landing ramps with built in food trays located directly in front of each door to guide pigeons directly into the trap. It includes a 36 x 24" shade screen which covers the entire top to prevent birds from overheating in direct sunlight. It also has a built in 5.5 x 5.5 x 2" food tray and 1 gallon water bowl to accommodate trapped birds for extended periods. And it features a slide out galvanized sheet metal tray that covers the entire bottom which prevents messy and damaged roofs. There are also two access doors for easy bird removal. This trap measures 36L x 24W x 10H and weighs 23 pounds. It is designed to catch and hold up to 30 pigeons.

Inside of clear plastic bag you will find:

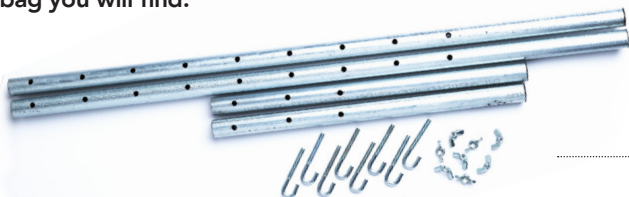

8 – J-bolts

8 – thumb screws

2 – 12" trap legs

2 – 24" trap legs

4 – plastic leg inserts (already inserted)

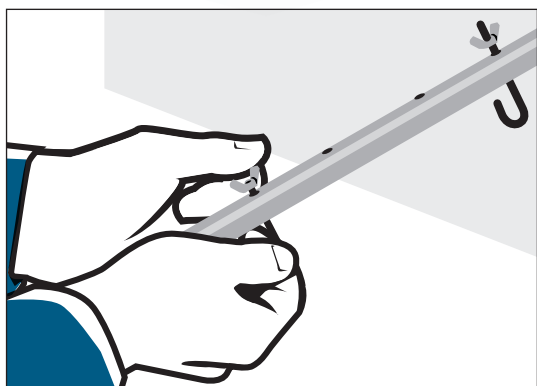
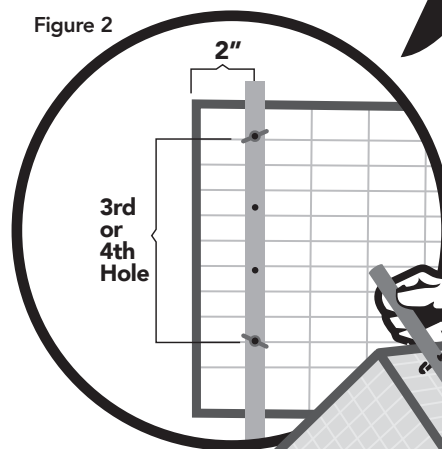

Figure 2



1) Prepare the legs by inserting two J-bolts into appropriate leg holes to achieve desired trap height. J-bolts must be spaced 3-4 holes apart for adequate support. Loosely place the wing-nut onto the J-bolt.

2) Lay trap so one of the longest sides faces you, Tip up on the long edge to start adding the legs.

Note: place the same length legs on the same side of the trap

Be sure plastic inserts in the legs are at bottom of trap to protect from damaging your roof

3) Secure leg to trap by looping both J-bolts around trap wire 2" from corner and tighten wing nuts until snug. See figure 2 and 3

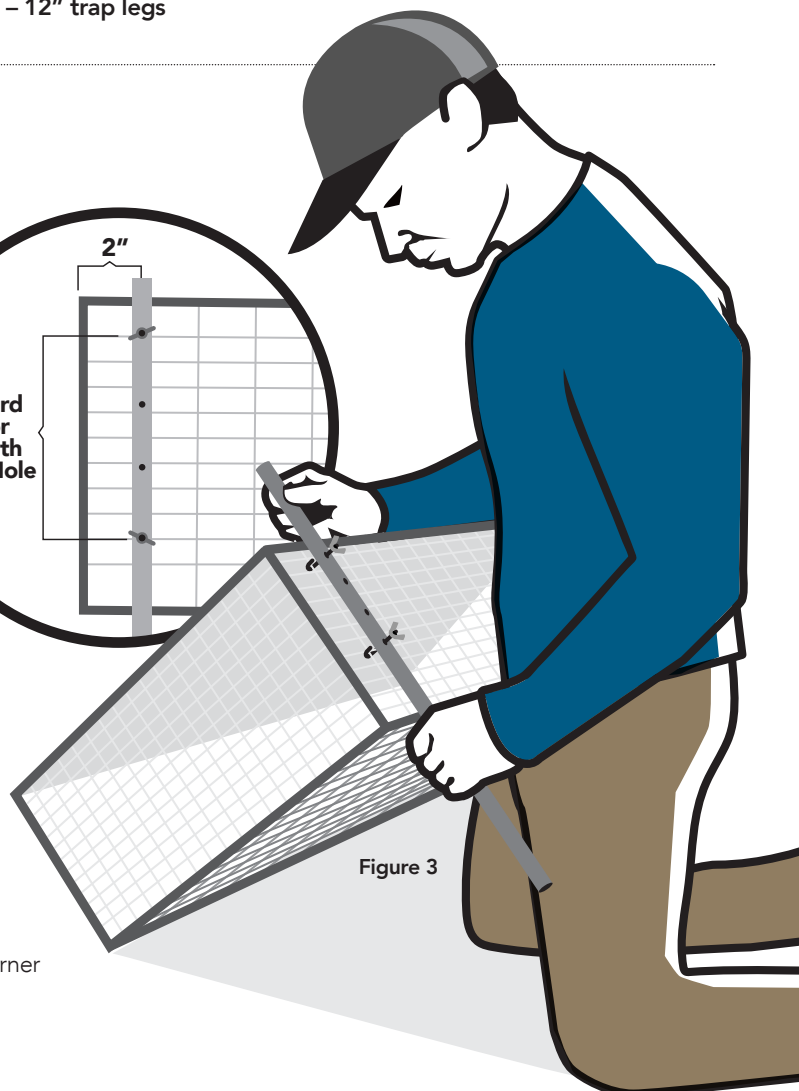
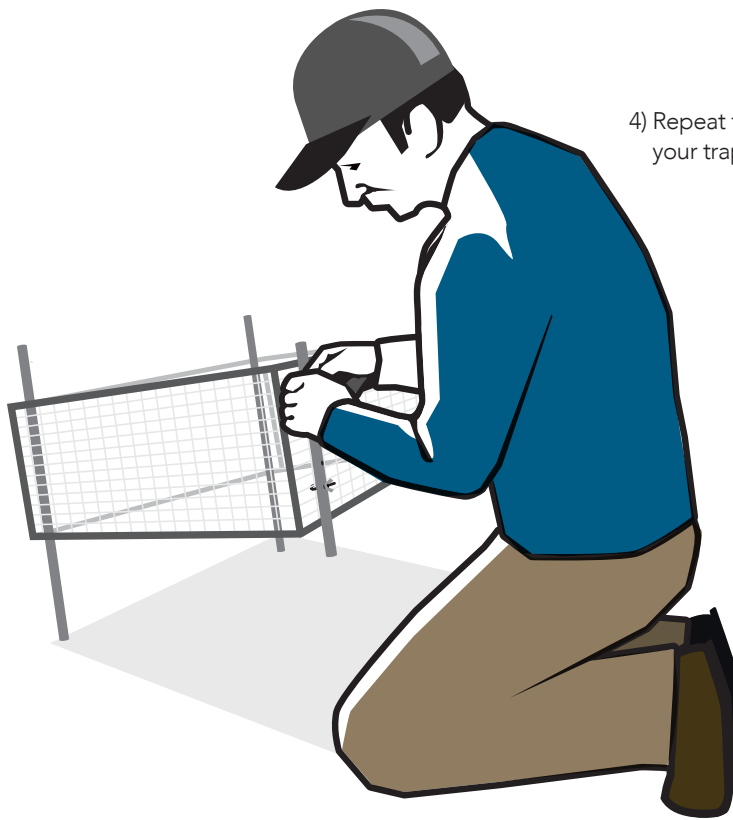
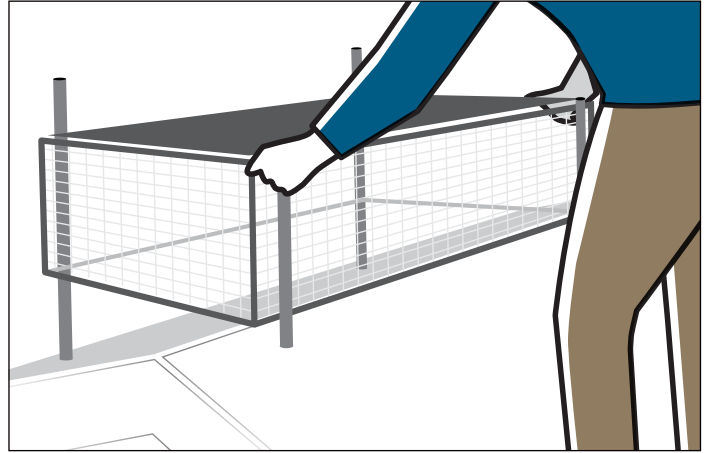

Figure 3



4) Repeat this process for remaining legs. Once complete, your trap is ready to be placed on your roof.



5) To bait, unlatch the ramp by lifting up on the J-spring until free. Let the ramp swing down until the chains are fully extended.

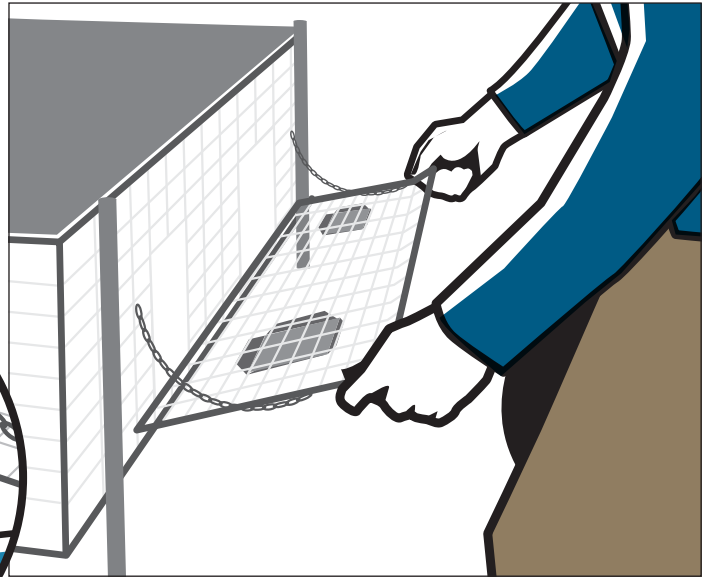

6) Secure ramp J-spring to trap to prevent ramp from moving.

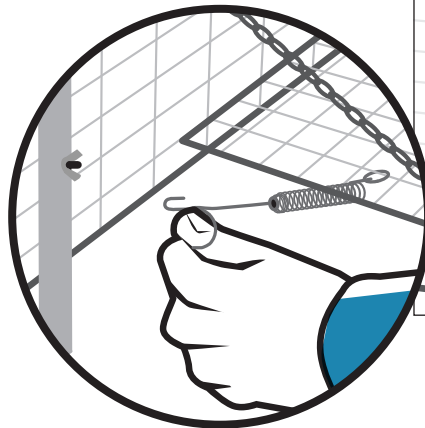

7) Add food to the ramp pans as well as the main trap pan. Water can be added to the included water container. Just open the shaded lid to access.

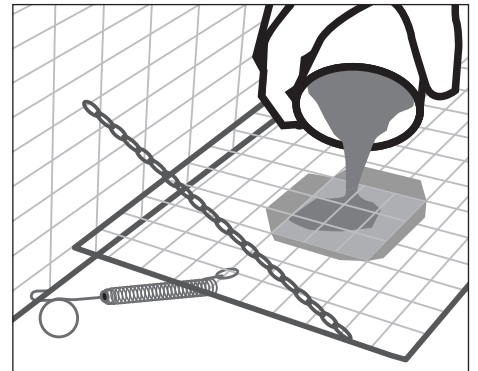

Tomahawk llc.
L I V E ■ T R A P

One Year
FACTORY WARRANTY



Mfg Animal
Equipment Since
1925
www.livetrap.com

Call: 800-272-8727 • Online: www.livetrap.com